

# PRODUCT DATA DRAWING

REVISION HISTORY			
REV	DESCRIPTION	DATE	APPROVED
G	DCN 32901	03/05	BRT

**MATERIAL**

BODY  
FERRULE,  
COUPLING NUT: STAINLESS STEEL PER AMS-5640,  
ALLOY UNS S30300, TYPE 303. COND. A

PRESS CAP: STAINLESS STEEL PER ASTM A240,  
ALLOY UNS S30400, TYPE 304

LOCK RING: BERYLLIUM COPPER PER ASTM B196,  
COND. TD04, ALLOY UNS C17300

CONTACT: BRASS PER ASTM B16, ALLOY UNS C36000

INSULATOR: PTFE PER ASTM D1710, TYPE I, GRADE 1,  
CLASS B

GASKET: SILICONE RUBBER PER A-A-59588,  
CLASS 2B, GRADE 50/60

**FINISH**

BODY  
FERRULE,  
CONTACT,  
PRESS CAP: GOLD PER ASTM B488, TYPE II,  
CODE C, CLASS 0.76; OVER NICKEL  
PER AMS-QQ-N-290, CLASS 1, .00010 MIN.

COUPLING NUT: PASSIVATED PER AMS-QQ-P-35, TYPE II

**PERFORMANCE**

IMPEDANCE: 50 OHMS  
FREQ. RANGE: DC TO 12.4 GHz  
D.W.V.: 1000 VRMS  
INSUL. RES.: 5000 MEGOHMS

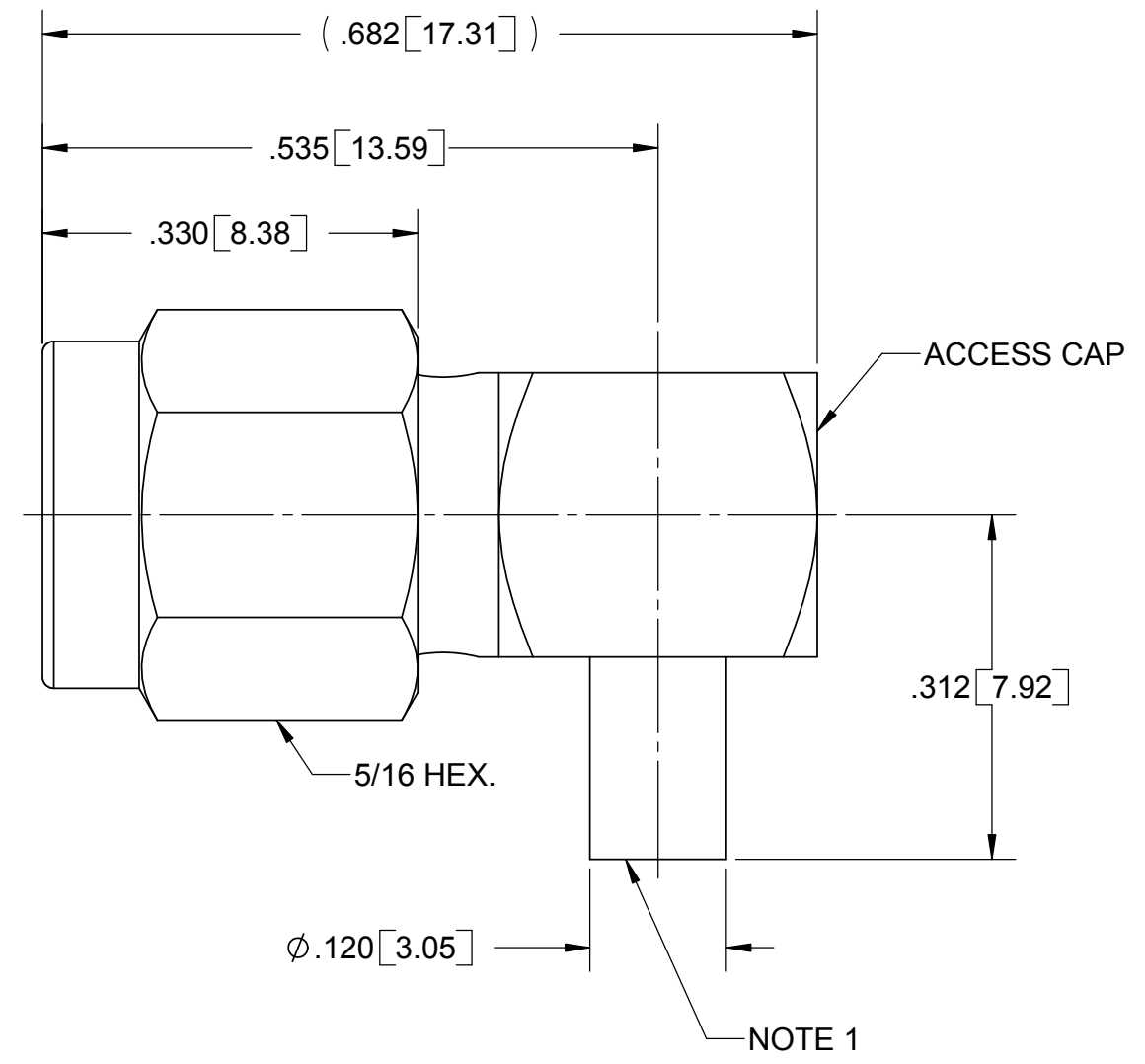

**NOTES:**  
1. ACCEPTS .085 SEMI-RIGID CABLE AND T-FLEX 405 CABLE

MATERIAL: SEE ABOVE	DIMENSIONS ARE IN INCHES TOLERANCES: FRACTIONAL: ±1/64 ANGULAR: X° ±1'0" X°X' ±15'	UNLESS OTHERWISE SPECIFIED 1) ALL DIMENSIONS ARE IN INCHES[MILLIMETERS] 2) ALL DIMENSIONS ARE AFTER PLATING. 3) BREAK CORNERS & EDGES .005 R. MAX. 4) CHAM. 1ST & LAST THREADS. 5) SURFACE ROUGHNESS 63 √ MIL-STD-10. 6) DIA.'S ON COMMON CENTERS TO BE CONCENTRIC WITHIN .005 T.I.R. 7) REMOVE ALL BURRS	<b>SV Microwave, Inc.</b> 2400 Centrepark West Drive, Suite 100 West Palm Beach, FL 33409
FINISH: SEE ABOVE	DECIMAL: X ±.030 .XX ±.010 .XXX ±.005	INTERPRET DIMENSIONS AND TOLERANCES PER ASME Y14.5M - 1994	TITLE: SMA PLUG RIGHT ANGLE SOLDER-ON
SURFACE AREA: N/A	<b>THIRD ANGLE PROJECTION</b>	DRAWN: BRT 04/04/97	SIZE: <b>B</b> CAGE CODE: <b>95077</b> DWG. NO.: <b>SF2915-6001</b>
<b>PROPRIETARY</b> THE INFORMATION CONTAINED IN THIS DRAWING IS THE SOLE PROPERTY OF SV MICROWAVE, INC. ANY REPRODUCTION IN PART OR AS A WHOLE WITHOUT THE WRITTEN PERMISSION OF SV MICROWAVE, INC IS PROHIBITED.		CHECKED: CT 10/15/85 APPROVED: ND 10/16/85	SCALE: 6:1 SHEET 1 OF 1