

10 9 8 7 6 5 4 3 2 1

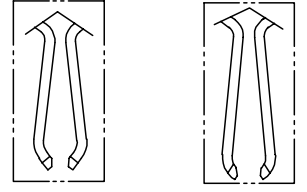

SHORT BLADE OPTION LONG BLADE OPTION  
**DETAIL R**  
 (SEE TABLE FOR BLADE OPTION)

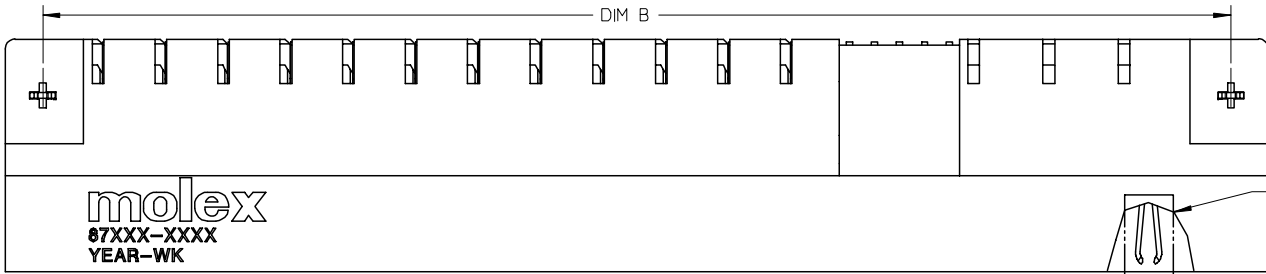
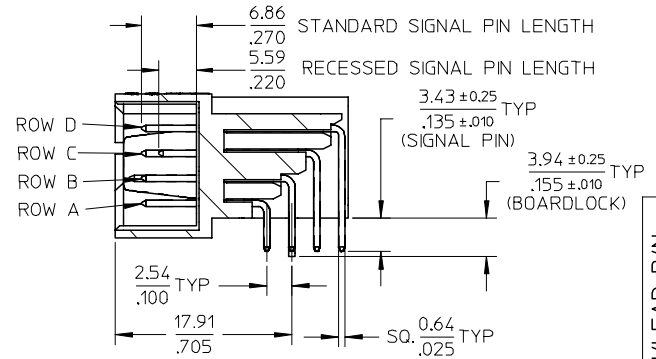
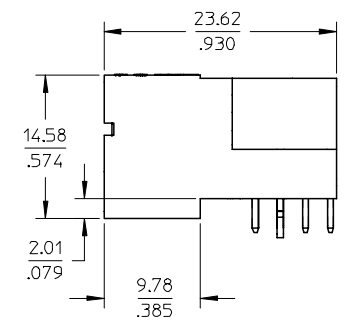
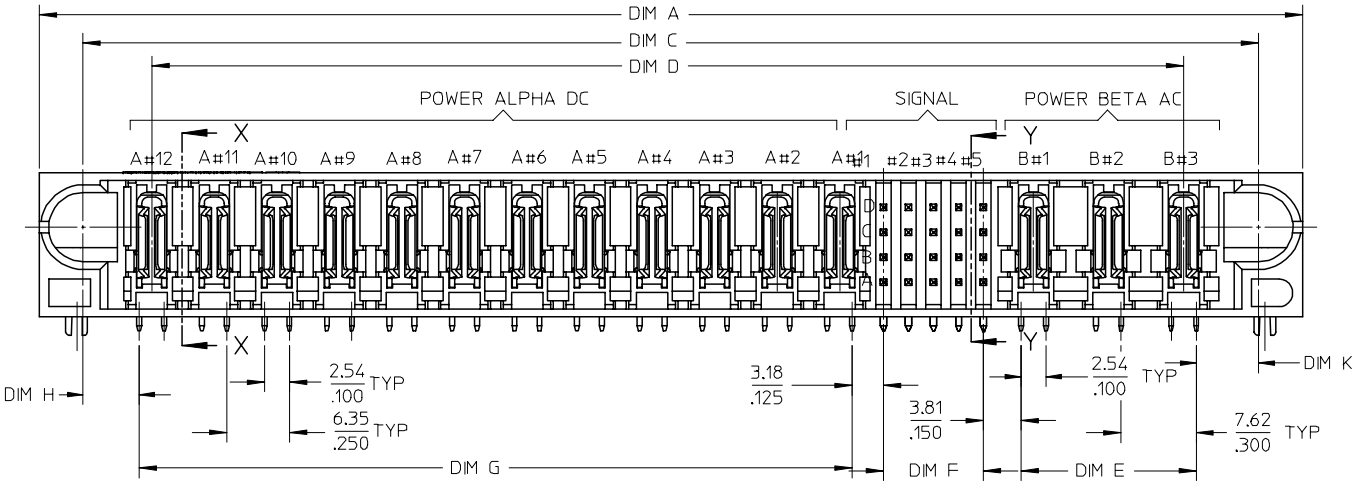

OBS EC NO: S2006-0767 DRWN:MLG CHKD:WAGESHKH APPR:PTL IM	2006/04/03	REV DESCRIPTION	QUALITY SYMBOLS
	2006/04/03		▽=0
	2006/04/06		▽=0

GENERAL TOLERANCES (UNLESS SPECIFIED)	DIMENSION STYLE	
	MM/IN	
	mm	INCH
	4 PLACES ± ---	± ---
3 PLACES ± ---	± .010	
2 PLACES ± 0.25	± ---	
1 PLACE ± ---	± ---	
ANGULAR ± 3 °		
DRAFT WHERE APPLICABLE MUST REMAIN WITHIN DIMENSIONS		

DRAWN BY	DATE
BHLOW	2003/10/02
CHECKED BY	DATE
PTL IM	2003/10/21
APPROVED BY	DATE
SKTOH	2003/10/21
MATERIAL NO.	SEE TABLE

SCALE	DESIGN UNITS	THIRD ANGLE PROJECTION
NTS	METRIC	
TITLE		
DC/AC POWER CONN. HEADER P(DC)-S-P(AC) CONFIG. R/A, T/H, BOARD-LOCK		
MOLEX INCORPORATED		
DOCUMENT NO.	SHEET NO.	
SD-87663-020	1 OF 3	
THIS DRAWING CONTAINS INFORMATION THAT IS PROPRIETARY TO MOLEX INCORPORATED AND SHOULD NOT BE USED WITHOUT WRITTEN PERMISSION		

9 8 7 6 5 4 3 2 1

10 9 8 7 6 5 4 3 2 1

F  
E  
D  
C  
B  
A

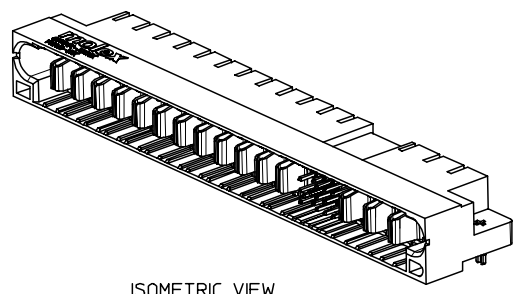

ISOMETRIC VIEW  
3P(AC)-24S-12P(DC) FOR ILLUSTRATION

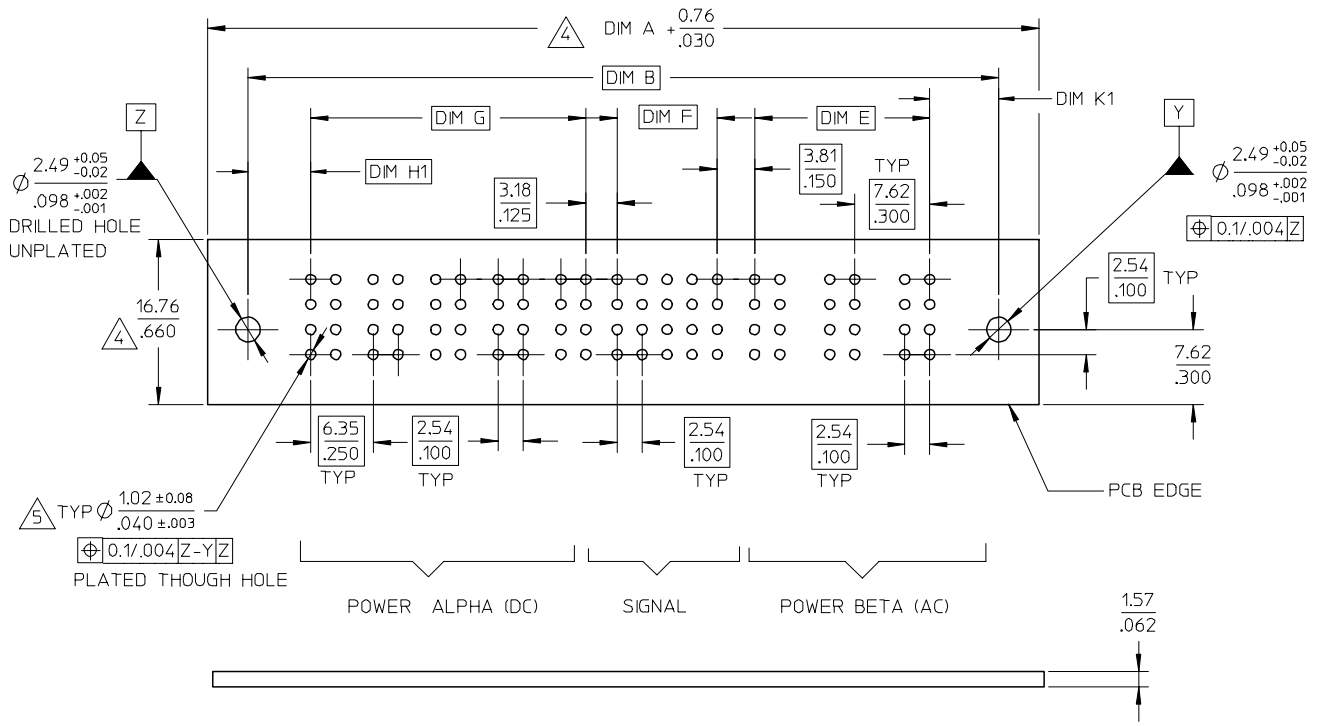

NOTES:

1. MATERIALS:-  
HOUSING - LCP, GLASS FILLED, UL94V-0. COLOUR: BLACK  
SIGNAL TERMINAL - COPPER ALLOY  
POWER TERMINAL - COPPER ALLOY
2. FINISH :-  
SIGNAL & POWER CONTACTS  
0.76 MICROMETER MINIMUM GOLD (Au) AT CONTACT AREA AND  
2.54 MICROMETER MINIMUM TIN AT SOLDERTAIL AREA  
OVER 1.27 MICROMETER MINIMUM NICKEL (Ni) UNDERPLATE.
3. PRODUCT SPECIFICATION : PS-87663-006.
4. COMPONENT STAY AWAY FROM CONNECTOR.
5. PCB NOTE FOR DIAMETER 1.02/.040 PLATED HOLE.  
- DRILLED HOLE SIZE IS 1.15/ .0453.  
- PLATE WITH 0.007 / .0003 MINIMUM TIN OVER 0.03/.001  
TO 0.08/.003 COPPER PLATING TO ACHIEVE 1.02±0.08/.040±.003 HOLE.
6. MANUFACTURER LOGO, PART NUMBER AND YEAR-WEEK CODE.
7. LONG AND SHORT CONTACT POWER BLADE OPTIONS ARE AVAILABLE  
FOR DIFFERENT CUSTOMERS REQUIREMENT.

OBS TIN/LEAD P/N EC NO: S2006-0767 DRWN:MLONG CHKD:NGESHKN APPR:PTLIM	REV D	DESCRIPTION 2006/04/03 2006/04/03 2006/04/06	QUALITY SYMBOLS ▽=0 ∇=0	GENERAL TOLERANCES (UNLESS SPECIFIED)		DIMENSION STYLE MM/IN		SCALE NTS	DESIGN UNITS METRIC	THIRD ANGLE PROJECTION			
				4 PLACES ± --- ± ---	3 PLACES ± --- ± .010	2 PLACES ± 0.25 ± ---	1 PLACE ± --- ± ---	DRAWN BY DATE		TITLE			
				ANGULAR ± 3 °				CHECKED BY DATE		DC/AC POWER CONN. HEADER P(DC)-S-P(AC) CONFIG. R/A, T/H, BOARD-LOCK			
				DRAFT WHERE APPLICABLE MUST REMAIN WITHIN DIMENSIONS				APPROVED BY DATE		MATERIAL NO. DATE		DOCUMENT NO. DATE	
				SIZE A3		SEE TABLE					SD-87663-020	MOLEX INCORPORATED	

9 8 7 6 5 4 3 2 1

PART NUMBER	P-S-P CONFIGURATION			DIM A	DIM B	DIM C	DIM D	DIM E	DIM F	DIM G	DIM H	DIM H1	DIM K	DIM K1	POWER BLADE OPTIONS		RECESSED SIGNAL PIN		VOID PIN LOCATION
	POWER ALPHA	DC SIGNAL	POWER BETA AC												DIM Z $\pm 0.13/.005$	LOCATION	LENGTH	LOCATION	
87663-2000	12	20	3	$\frac{128.27}{5.050}$	$\frac{120.65}{4.750}$	$\frac{119.38}{4.700}$	$\frac{104.78}{4.125}$	$\frac{17.78}{.700}$	$\frac{10.16}{.400}$	$\frac{72.39}{2.850}$	$\frac{5.72}{.225}$	$\frac{6.35}{.250}$	$\frac{6.35}{.250}$	$\frac{6.99}{.275}$	14.12 / .556	ALL	5.59/.220	A1,A3,C3 .D1,D2	NIL
87663-2001	8	12	3	$\frac{97.79}{3.850}$	$\frac{90.17}{3.550}$	$\frac{88.90}{3.500}$	$\frac{74.30}{2.925}$	$\frac{17.78}{.700}$	$\frac{5.08}{.200}$	$\frac{46.99}{1.850}$	$\frac{5.72}{.225}$	$\frac{6.35}{.250}$	$\frac{6.35}{.250}$	$\frac{6.99}{.275}$	14.12 / .556	ALL	NIL	NIL	NIL
87663-2002	1	32	3	$\frac{64.14}{2.525}$	$\frac{56.52}{2.225}$	$\frac{55.25}{2.175}$	$\frac{42.55}{1.675}$	$\frac{17.78}{.700}$	$\frac{17.78}{.700}$	$\frac{2.54}{.100}$	$\frac{5.08}{.200}$	$\frac{5.72}{.225}$	$\frac{5.08}{.200}$	$\frac{5.72}{.225}$	14.12 / .556	ALL	NIL	NIL	A5,B5,C5,D5 A6,B6,C6,D6 B7,C7 A8,B8,C8,D8

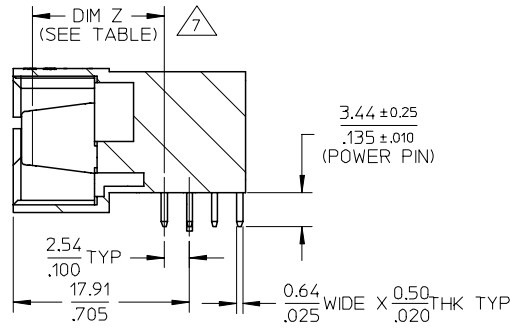

(TERMINAL LOCKING DETAIL NOT SHOWN)

SECTION X-X

OBS TIN/LEAD P/N EC NO: S2006-0767 DRWN:MLONG CHKD:WAGESHKN APPR:PTLIM	QUALITY SYMBOLS ▽=0 ▽C=0	GENERAL TOLERANCES (UNLESS SPECIFIED)		DIMENSION STYLE MM/IN		SCALE NTS	DESIGN UNITS METRIC	THIRD ANGLE PROJECTION		
		4 PLACES	± ---	± ---	DRAWN BY BHLW	DATE 2003/10/02	TITLE DC/AC POWER CONN. HEADER P(DC)-S-P(AC) CONFIG. R/A, T/H, BOARD-LOCK			
		3 PLACES	± ---	± .010	CHECKED BY PTLIM	DATE 2003/10/21				
		2 PLACES	± 0.25	± ---	APPROVED BY SKTOH	DATE 2003/10/21	MOLEX INCORPORATED			
1 PLACE	± ---	± ---	MATERIAL NO.		DOCUMENT NO. SD-87663-020		SHEET NO. 3 OF 3			
D	REV	DRAFT WHERE APPLICABLE MUST REMAIN WITHIN DIMENSIONS		SEE TABLE		THIS DRAWING CONTAINS INFORMATION THAT IS PROPRIETARY TO MOLEX INCORPORATED AND SHOULD NOT BE USED WITHOUT WRITTEN PERMISSION				